



# Z150F FLOFORCE™ PROMENADE DECK DRAIN GENERAL INSTALLATION INSTRUCTIONS

Design and Dimensional Data (inches and [ mm ]) are Subject to Manufacturing Tolerances and Change Without Notice

Step 1 - Install and secure the roof drain body into the subsurface roof structure as required to prevent any vertical or horizontal movement. The flange of the drain body must be installed so that it is no higher than the roof membrane to prevent water retention on the roof. Likewise, the flange should not be installed any lower than what is approved by the involved roofing products of the project.

Step 2 - Install and secure a waterproofing membrane to the roof body with the clamping collar.

- a. Apply the water proofing membrane fully over the roof drain.
- b. Locate the clamping collar tappings in the top surface of the drain body and create bolt clearance holes in the membrane at corresponding locations.
- c. Seal the membrane to the drain body per manufacturer's instructions.
- d. Align the clamping collar bolt holes with the drain body tappings and set the collar onto the membrane and body.
- e. Insert clamping collar hardware through the holes and hand tighten down in a star pattern progressively. (Fig. 1a, Fig. 1b)
- f. Tighten the bolts securely in the patterns shown (Fig. 1a shows 2 thru 4 [51 thru 102] outlets and Fig. 1b shows 6 thru 8 [152 thru 203] outlets) to 25 ft-lbs maximum torque.

**CAUTION: Over-torque of the bolts can cause damage to the clamping collar and/or drain body and compromise sealing of the membrane. DO NOT use an impact driver to tighten down the hardware.**

Step 3 - Cut the membrane as per the roof membrane manufacturer's requirements in the center of the clamping collar. Continue to cut outward until the precast cutting edge in the drain body is located (Fig 2). Once the precast edge is found, cut out circular section of the membrane by following the cutting edge and cutting around the four securing bosses spaced inward on the collar.

**Note: Failure to properly cut the membrane along the prescribed cut edge of the drain body may result in decreased flow performance of the drain.**

Step 4 - Set the rotatable frame down on top of the clamping collar, center the frame, and align the orientation of the frame as necessary.

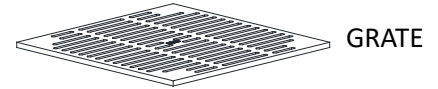

GRATE

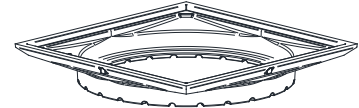
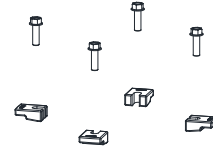

FRAME

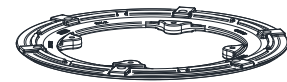

CLAMPING COLLAR

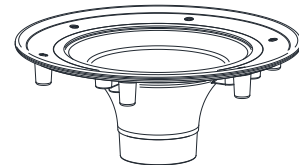

DRAIN BODY

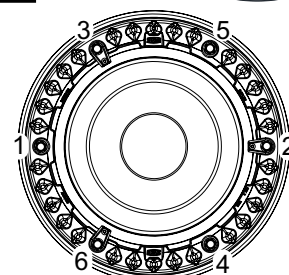

Fig. 1a

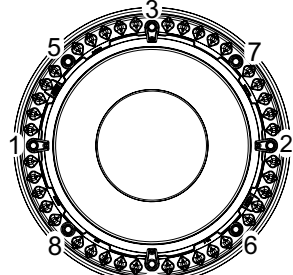

Fig. 1b

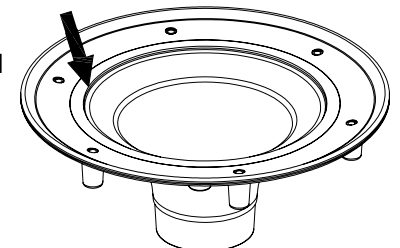

Fig. 2

**⚠ WARNING:** Cancer and Reproductive Harm - [www.P65Warnings.ca.gov](http://www.P65Warnings.ca.gov)

**⚠ ADVERTENCIA:** Cáncer y daño reproductivo - [www.P65Warnings.ca.gov](http://www.P65Warnings.ca.gov)

**⚠ AVERTISSEMENT:** Cancer et effets néfastes sur la reproduction - [www.P65Warnings.ca.gov](http://www.P65Warnings.ca.gov)

Zurn Industries, LLC | Specification Drainage Operation  
1801 Pittsburgh Avenue, Erie, PA 16502, Ph. 855.663.9876

In Canada | Zurn Industries Limited  
7900 Goreway Drive, Unit 10, Brampton, Ontario L6T 5W6, Ph. 877.892.5216

[www.zurn.com](http://www.zurn.com)

Rev. -  
Date: 05/16/2023  
C.N. No. 145338  
Patent [zurn.com/patents](http://zurn.com/patents)  
Form No. RD154

Page 1 of 2



# Z150F FLOFORCE™ PROMENADE DECK DRAIN GENERAL INSTALLATION INSTRUCTIONS

Design and Dimensional Data (inches and [ mm ]) are Subject to Manufacturing Tolerances and Change Without Notice

Step 5 - Place the four clamp dogs on top of the bottom rim of the frame and align the slots in each clamp dog with the tappings in the clamping collar. Insert a bolt through each clamp dog slot and thread into the clamping collar. (Fig. 3) Hand-tighten the bolts until final alignment adjustments are made to the frame. Once the frame is in proper position, tighten the four clamp dog bolts down to a torque of 20-25 ft-lbs.

**Note: Adjustments to the orientation of the frame can be made prior to finish of roof surface.**

Step 6 - Complete construction of the promenade deck surface as required so that finished roof surface is flush with top of frame. (Fig 4)

Step 7 - Set the loose grate onto the seating surface of the frame and center.

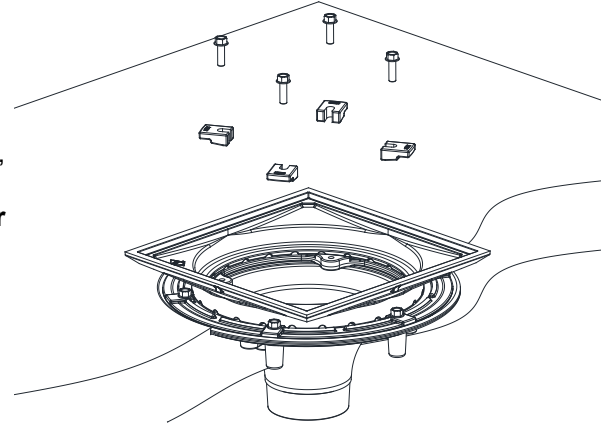

Fig 3

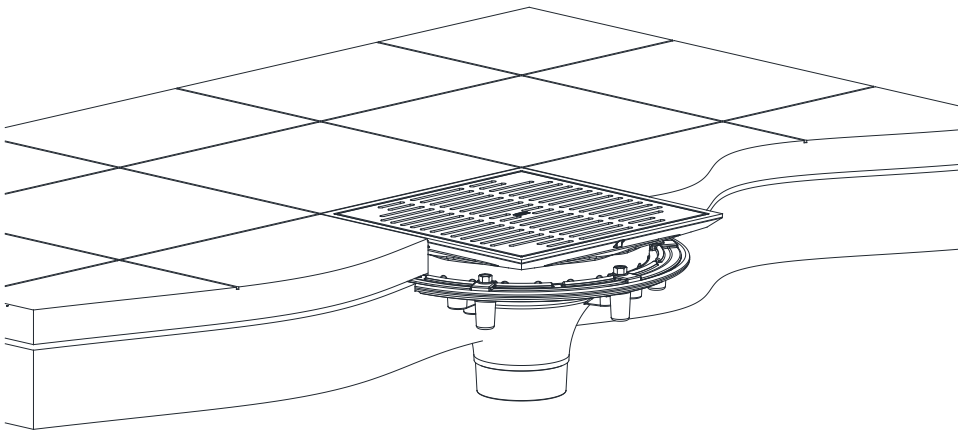

Fig 4

⚠ **WARNING:** Cancer and Reproductive Harm - [www.P65Warnings.ca.gov](http://www.P65Warnings.ca.gov)

⚠ **ADVERTENCIA:** Cáncer y daño reproductivo - [www.P65Warnings.ca.gov](http://www.P65Warnings.ca.gov)

⚠ **AVERTISSEMENT:** Cancer et effets néfastes sur la reproduction - [www.P65Warnings.ca.gov](http://www.P65Warnings.ca.gov)

Zurn Industries, LLC | Specification Drainage Operation  
1801 Pittsburgh Avenue, Erie, PA 16502, Ph. 855.663.9876

In Canada | Zurn Industries Limited  
7900 Goreway Drive, Unit 10, Brampton, Ontario L6T 5W6, Ph. 877.892.5216

[www.zurn.com](http://www.zurn.com)

Rev.	-
Date:	05/16/2023
C.N. No.	145338
Patent	<a href="http://zurn.com/patents">zurn.com/patents</a>
Form No.	RD154

Page 2 of 2