



Z150F-E FLOFORCE™ PROMENADE DECK DRAIN WITH STATIC EXTENSION INSTALLATION INSTRUCTIONS

Design and Dimensional Data (inches and [mm]) are Subject to Manufacturing Tolerances and Change Without Notice

Step 1 - Install and secure the roof drain body into the subsurface roof structure as required to prevent any vertical or horizontal movement.

Step 2 - Insert the provided threaded rod into the corresponding tappings on the top surface of the drain body. Thread the rods down until they are hand-tight.

Step 3 - Align the flat extension gasket so that the bolt holes in the gasket correspond with the threaded rods. Slide each hole over the rods until the gasket is laying flat on the roof drain body.

Step 4 - Align the extension so that the bolt holes correspond with the threaded rods. Slide the extension onto the assembly until it rests on the flat gasket. Ensure that the gasket is not pinched or folded and is visible all around, both on the inside and outside of the extension. The flange of the extension body must be installed so that it is no higher than the roof membrane to prevent retention of water on the roof.

Step 5 - Install roof insulation (as required) to flush with the top outer flange of the extension body.

Step 6 - Install and secure a waterproofing membrane to the roof extension body with the clamping collar.

a. Apply the water proofing membrane fully over the roof drain extension.

b. Locate the threaded rods protruding up from the extension body and create clearance holes in the membrane at corresponding locations.

c. Seal the membrane to the extension body per manufacturer's instructions.

d. Align the clamping collar bolt holes with the protruding threaded rods and set the collar onto the membrane and extension.

e. Apply provided jam nuts onto the threaded rods and hand tighten down in a star pattern progressively. (Fig 1a, Fig 1b)

f. If reinforced membranes are used or the membrane is suspended above drain and hardware is used to pull membrane down to extension body, hardware must be tightened in a progressive star pattern.

CAUTION: Forcing membrane down to extension body using only two opposite bolts can break the clamping collar and is not covered under product warranty.

g. Tighten the jam nuts securely to compress both the applied roof membrane and the extension gasket below.

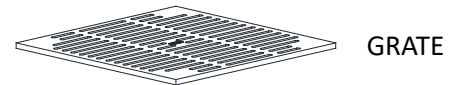

GRATE



FRAME

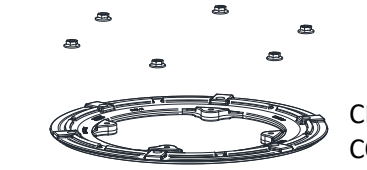

CLAMPING
COLLAR

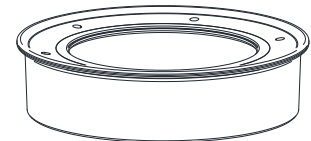

EXTENSION
BODY

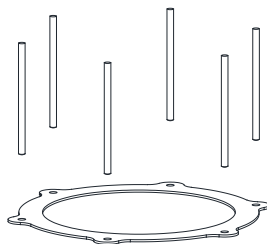

DRAIN BODY

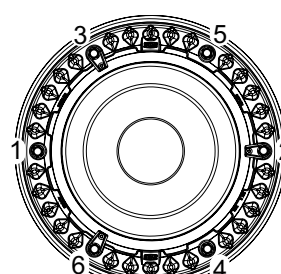

Fig. 1a

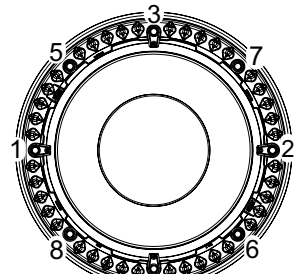

Fig. 1b

⚠ **WARNING:** Cancer and Reproductive Harm - www.P65Warnings.ca.gov

⚠ **ADVERTENCIA:** Cáncer y daño reproductivo - www.P65Warnings.ca.gov

⚠ **AVERTISSEMENT:** Cancer et effets néfastes sur la reproduction - www.P65Warnings.ca.gov

Zurn Industries, LLC | Specification Drainage Operation
1801 Pittsburgh Avenue, Erie, PA 16502, Ph. 855.663.9876

In Canada | Zurn Industries Limited
7900 Goreway Drive, Unit 10, Brampton, Ontario L6T 5W6, Ph. 877.892.5216

www.zurn.com

Rev. -
Date: 05/17/2023

C.N. No. 145338
Patent zurn.com/patents

Form No. RD156

Page 1 of 2



Z150F-E FLOFORCE™ PROMENADE DECK DRAIN WITH STATIC EXTENSION INSTALLATION INSTRUCTIONS

Design and Dimensional Data (inches and [mm]) are Subject to Manufacturing Tolerances and Change Without Notice

Step 7 - Cut the membrane as per the roof membrane manufacturer's requirements in the center of the extension. Continue to cut outward until the precast circular edge in the extension is located (Fig 2). Once the precast edge is found, cut out circular section of the membrane by following the cutting edge.

Note: Failure to properly cut the membrane along the prescribed cut edge of the extension may result in decreased flow performance of the drain.

Step 8 - Set the rotatable frame down on top of the clamping collar, center, and align the orientation of the frame as necessary.

Step 9 - Place the four clamp dogs on top of the bottom rim of the frame and align the slots in each clamp dog with the tappings in the clamping collar. Insert a bolt through each clamp dog slot and thread into the clamping collar. (Fig 3) Hand-tighten the bolts until final alignment adjustments are made to the frame. Once the frame is in proper position, tighten the four clamp dog bolts down to a torque of 20-25 ft-lbs.

Note: Adjustments to the orientation of the frame can be made prior to finish of roof surface.

Step 10 - Complete construction of the promenade deck surface as required so that finished roof surface is flush with top of frame. (Fig 4)

Step 11 - Set the loose grate onto the seating surface of the frame and center.

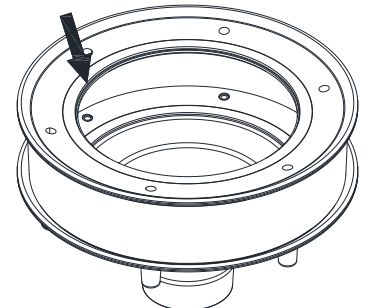

Fig. 2

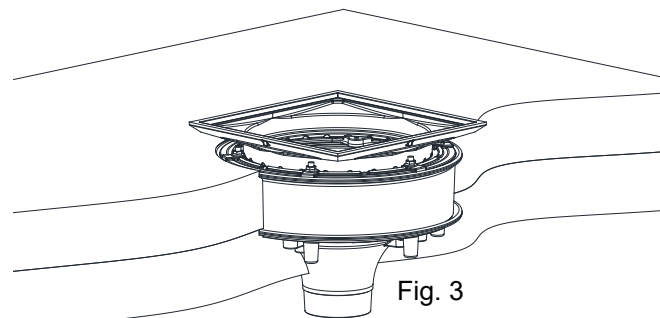

Fig. 3

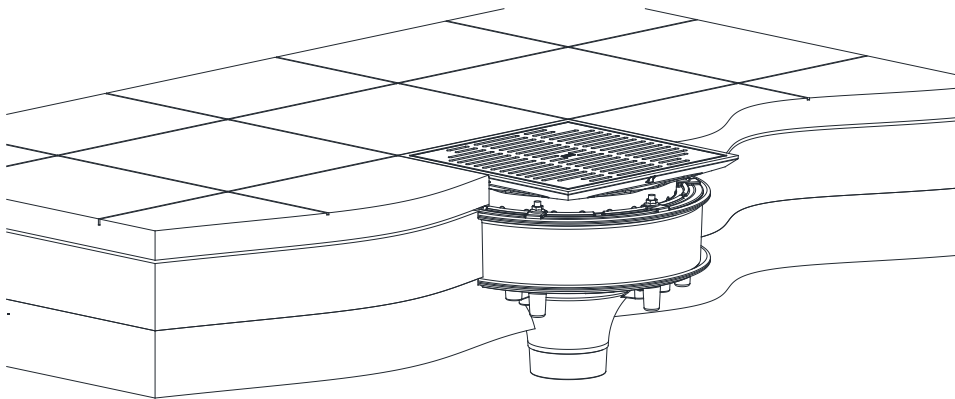

Fig. 4

⚠ **WARNING:** Cancer and Reproductive Harm - www.P65Warnings.ca.gov

⚠ **ADVERTENCIA:** Cáncer y daño reproductivo - www.P65Warnings.ca.gov

⚠ **AVERTISSEMENT:** Cancer et effets néfastes sur la reproduction - www.P65Warnings.ca.gov

Zurn Industries, LLC | Specification Drainage Operation
1801 Pittsburgh Avenue, Erie, PA 16502, Ph. 855.663.9876

In Canada | Zurn Industries Limited
7900 Goreway Drive, Unit 10, Brampton, Ontario L6T 5W6, Ph. 877.892.5216

www.zurn.com

Rev. -
Date: 05/17/2023
C.N. No. 145338
Patent zurn.com/patents
Form No. RD156

Page 2 of 2