

Z1174

Installation and Operation Instructions

Z1174

Replaces Z1174 Poly-Zyme



Concentrated Biotechnical Treatment For Grease Interceptors

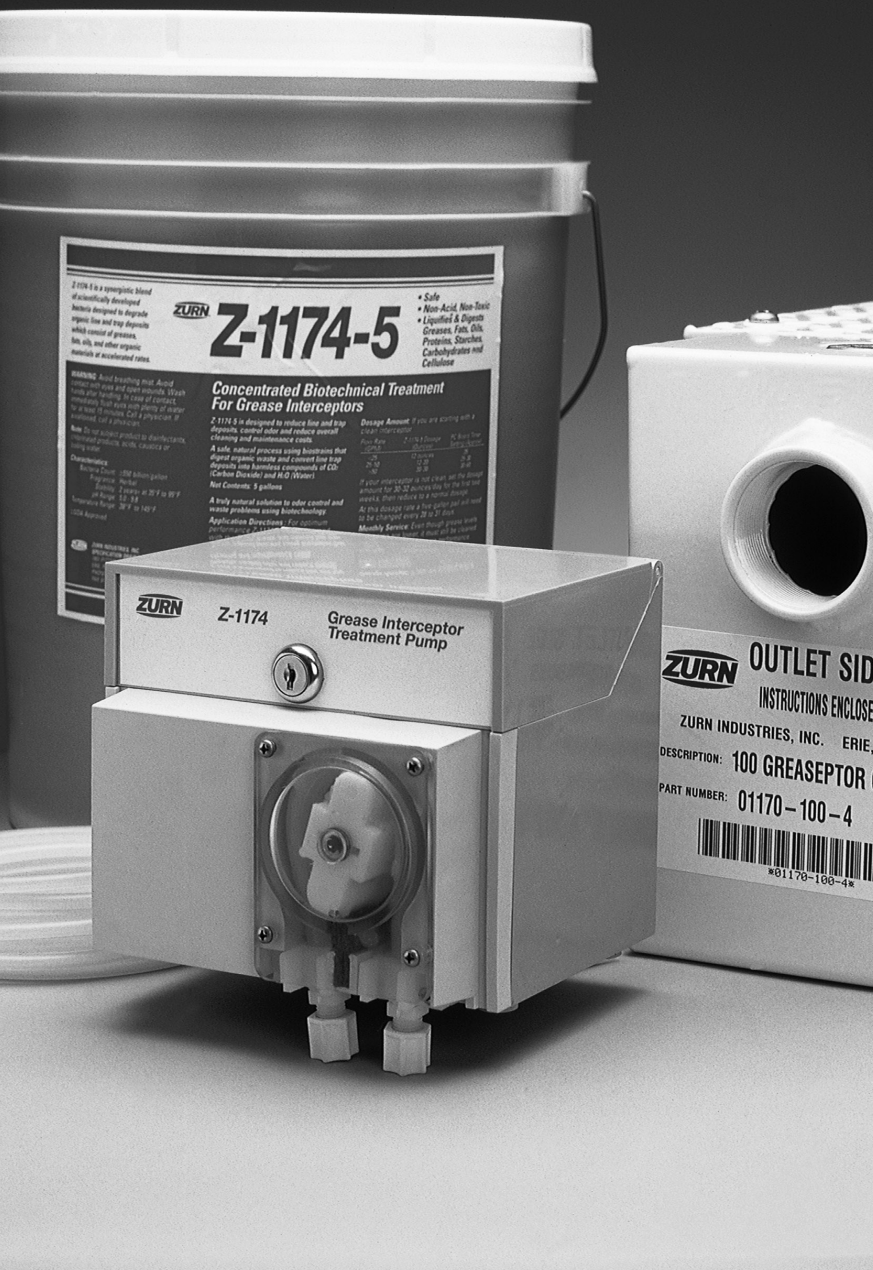

- Reduces Maintenance of Grease Interceptors
- Eliminates Most Bad Odors
- Easy to Use
- Economical
- Safe
- Bacteria-Based Solution Specifically Engineered to Digest Grease

INSTALLATION INSTRUCTIONS

Before Installing:

It is highly recommended that the grease interceptor be emptied and cleaned completely. This will give the quickest elimination of odors. If the interceptor cannot be emptied and cleaned, all the grease should be removed.

PUMP INSTALLATION

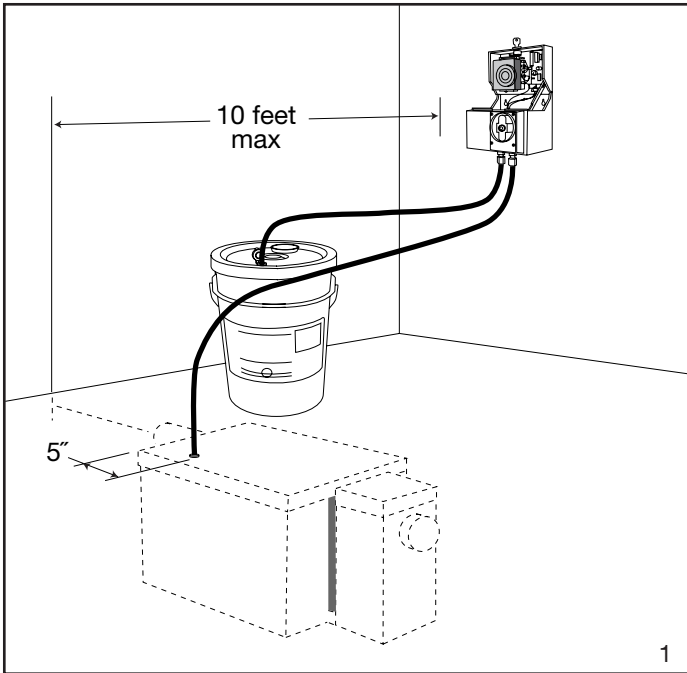

1 Select a dry location to mount the pump. Attach the unit to the wall as close as possible to the Z1174 bacteria container and the interceptor. Supply tubing should not exceed 10 feet to or from the pump. ***Retrofit Kit (-RK) Installation:** Drill a 7/16" hole in the interceptor cover five inches from the inlet side of the interceptor. It is very important to center the hole between scorations on the surface of the interceptor cover.

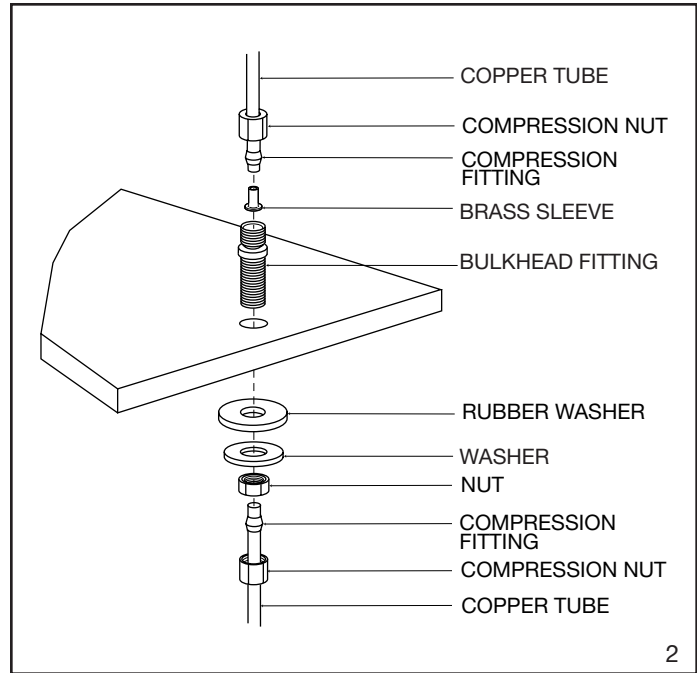

2 Install the bulkhead fitting through the 7/16" hole on the interceptor cover using the gasket, washer and nut provided. Tighten the nut to ensure compression of the rubber washer. The copper tube may be longer than necessary – it should extend to approximately 3"-4" from the bottom of the interceptor. Cut if necessary. The brass sleeve is inserted to the end of the plastic supply tube, which is connected to the outside end of the bulkhead fitting. **Note:** This connection must be air and water tight or performance of interceptor will be negatively affected.

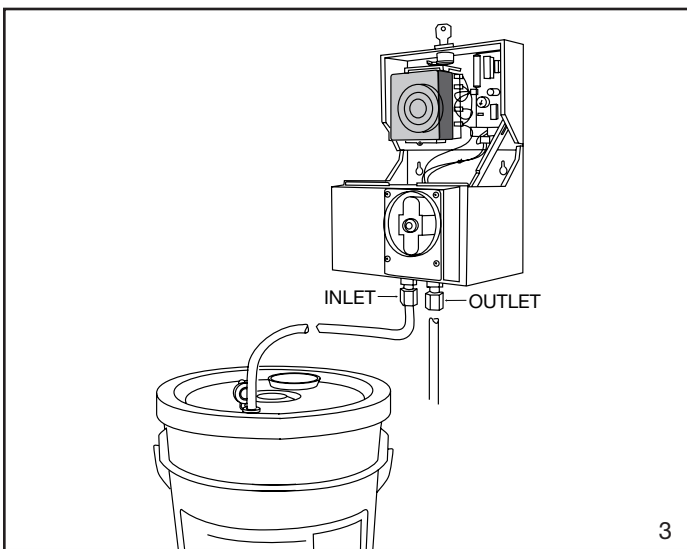

3 Attach draw hose to inlet side of pump. Attach the supply hose to the outlet side of the pump. Make sure the compression fittings have the stainless steel ring and the ferrule installed correctly. Insert hoses into fittings completely and hand tighten. The supply tube should be inserted into the Z1174 bacteria bucket through the small access cap until it touches the bottom.

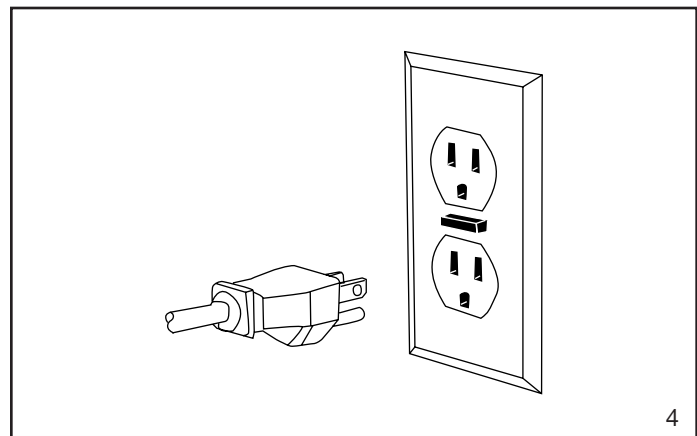

4 Plug pump into wall outlet. A GFCI receptacle is recommended. If the cord is not long enough, use a grounded extension cord at least 18 AWG. As with any electrical work, check your local codes first.

SETTING THE TIMER

The timing function of the pump unit is controlled by two methods. Power is sent to the electronics by the appliance-type timer in half-hour increments. The electronics then control the pump motor "ON" time by adjusting the dial on the electronics.

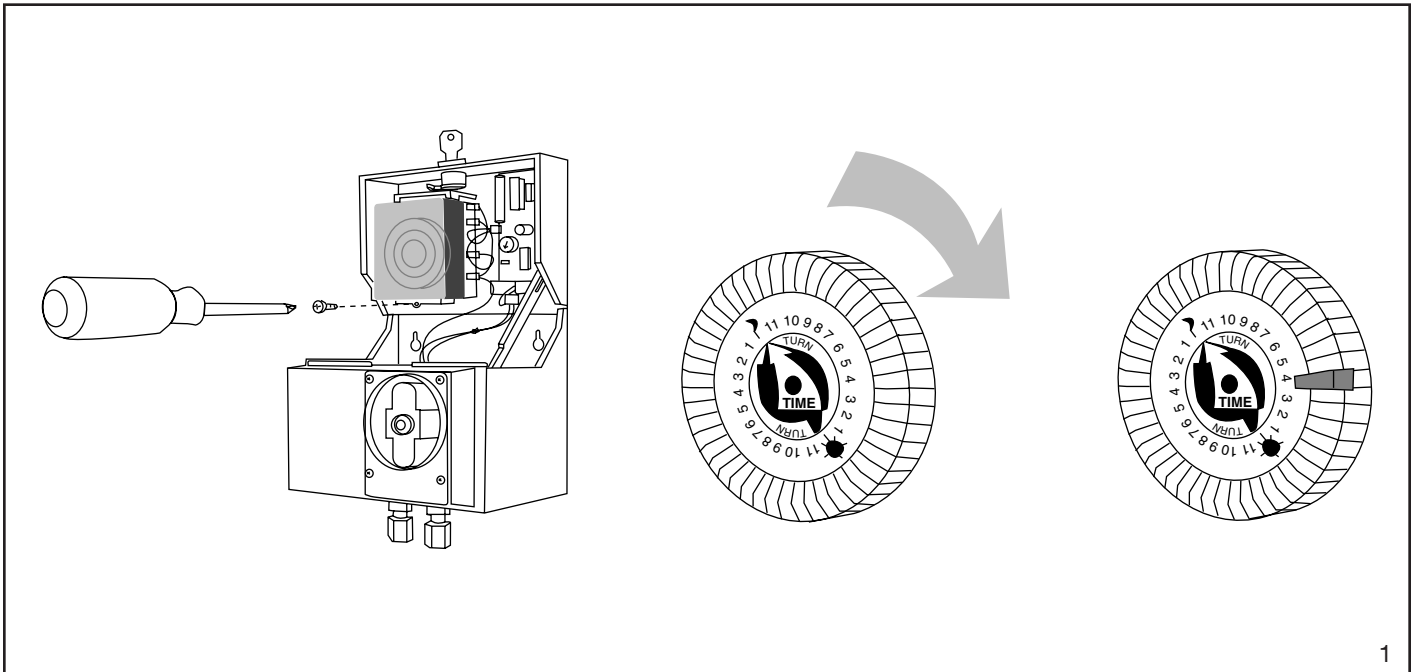

1 To set the current time, rotate the dial **clockwise** to the correct time. To select an "ON" time, lift the orange tab next to the time that you want the pump to turn on. An "UP" tab indicates that the pump turns on. A "DOWN" tab indicates that the pump will turn off. The Z1174 bacteria should be introduced into the interceptor after the kitchen is closed for the evening when little or no water is flowing through the interceptor. A one-half hour "ON" time should be adequate.

Interceptor Capacity	Daily Dose BIO-FILM (Ounces)	Pump Run Time (Approx.)	Dial Setting (Approx.)
To 25 gallons	12 oz.	2.5 min.	25
25 to 50 gallons	12 - 20 oz.	2.5 - 3.25 min.	25-30
50 gallons	20 - 30 oz.	3.25 - 6.5 min.	30-60

2 To determine the run time of the pump, use the chart above to determine the amount of Z1174 to be dispensed based on your interceptor capacity. If the interceptor has not been cleaned prior to the Z1174, the system may need to be shocked with a larger dose of Z1174 for the first month of operation. After this time, the recommended volume may be used. Specific installations may require more or less Z1174 – this chart is only a guideline. After the first month of use the amount of Z1174 may be reduced.

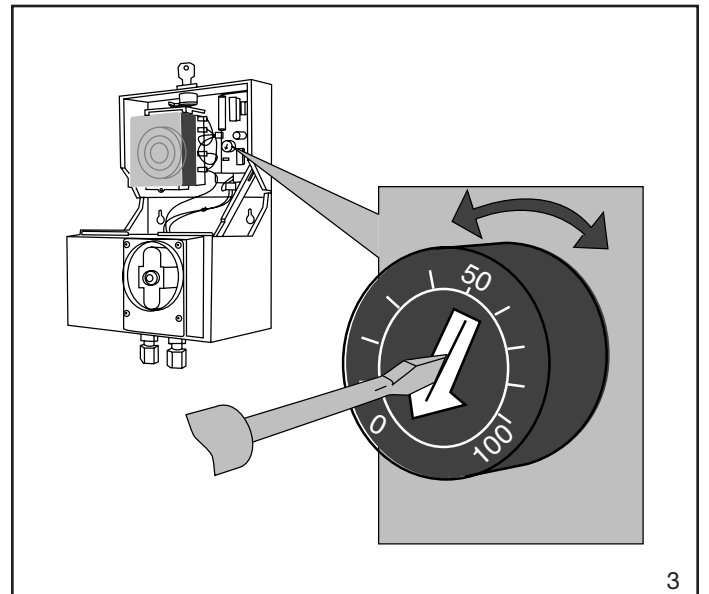

3 To set the desired run time (dial setting): On the circuit board there is a small dial marked "0" to "100." These numbers do not represent time. This can be adjusted by turning the dial with a small screwdriver clockwise to increase time and counterclockwise to decrease time. Check pump run time with a watch to ensure proper dosage.

CHARACTERISTICS

pH Range: 5.0 - 9.8
Temperature Range: 38°F - 145°F
Appearance: Blue
Fragrance: Herbal
USDA Approved

STORAGE AND HANDLING

Store in a cool, dry place.
Avoid inhalation, wash hands after contact, and avoid eye contact.

TROUBLESHOOTING GUIDE

PROBLEM	CAUSE	SOLUTION
Pump does not run.	The pump is unplugged.	Plug the pump in.
	The timer is not functioning.	Make sure the proper "on" tabs are up and the dial is on the proper setting.
Z1174 is not being drawn from the bucket.	Air is being drawn into the pump.	Make sure all the fittings are tight.
	The supply tube is not in the bucket far enough.	Make sure the supply tube is in the bucket and in contact with the Z1174.
	There is a kink in the hose.	Make sure the hose is free of kinks and sharp bends.
Z1174 does not seem effective.	pH is low.	Check the pH in the grease trap. The optimum level is (6.5 to 8.5).
	Z1174 pumped in during a flow time.	Reset the timer to pump during a low or no flow time.
	Chemicals being poured down the drain.	DO NOT pour bleaches, caustic chemicals or acids down the drain.

MAINTENANCE

1. Periodic maintenance is as simple as keeping the pump lubricated. This is done by applying a silicon grease such as "Permatex Super Lube" with Teflon® to the felt pad in the pump housing.

FOR Z1174 CONTACT YOUR LOCAL ZURN SALES REPRESENTATIVE.



ZURN INDUSTRIES, LLC Specification Drainage Operation
1801 Pittsburgh Avenue, Erie, PA 16502, 855-663-9876

In Canada: ZURN INDUSTRIES LIMITED 7900 Goreway Drive, Unit 10, Brampton, Ontario L6T 5W6, 905-405-8272

Form No. ZMKTG210-43, 6/18

⚠ **WARNING:** Cancer and Reproductive Harm - www.P65Warnings.ca.gov
⚠ **ADVERTENCIA:** Cáncer y daño reproductivo - www.P65Warnings.ca.gov
⚠ **AVERTISSEMENT:** Cancer et effets néfastes sur la reproduction - www.P65Warnings.ca.gov



US 1.855.ONE.ZURN CANADA 1.877.892.5216 ZURN.COM