



Z1731

9 [229] DIAMETER FLOOR DRAIN
MEDIUM DEPTH

SPECIFICATION SHEET

TAG _____

Dimensional Data (inches and [mm]) are Subject to Manufacturing Tolerances and Change Without Notice

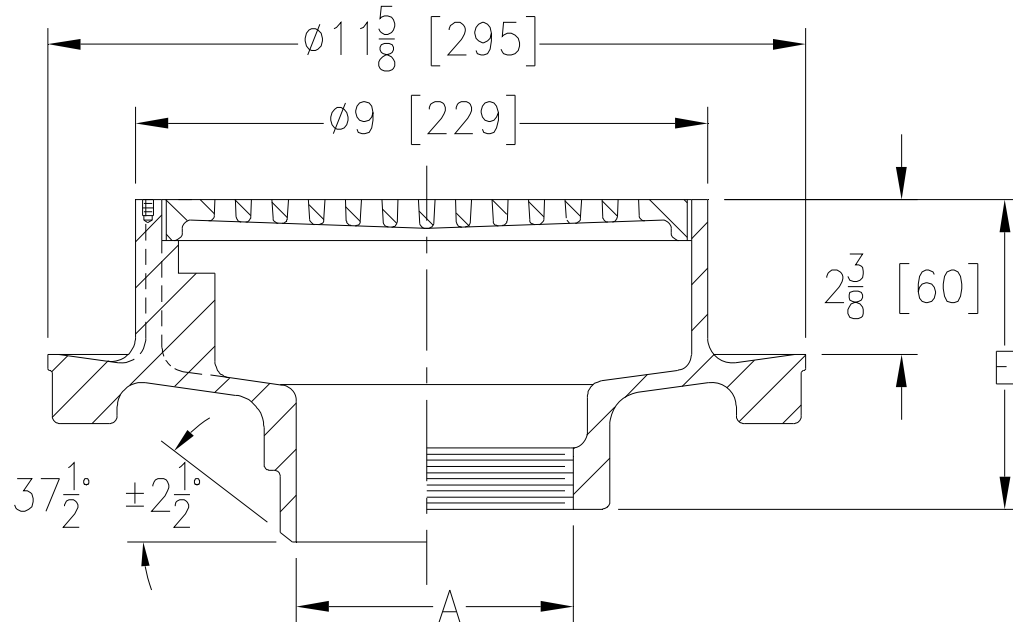

A Pipe Size In. [mm]	Approx. Wt. Lbs. [kg]	Grate Open Area Sq. In. [cm ²]
3, 4 [76, 102]	22 [10]	21 [135]

ENGINEERING SPECIFICATION: ZURN Z1731
9" [229mm] Diameter All Type 304 (CF8) stainless steel heavy-duty floor drain with integral anchor flange, and loose-set grate with plain finish.

OPTIONS (Check/specify appropriate options)

PIPE SIZE

3, 4 [76, 102]

(Specify size/type) **OUTLET**

- ___ BW Butt-weld
(Specify Schedule 10 or 40)
- ___ IC Inside Caulk
- ___ IP Threaded
- ___ NH No-Hub

'E' BODY HT. DIM.

- 5-11/16 [144]
- 5-11/16 [144]
- 5-11/16 [144]
- 5-11/16 [144]

PREFIXES

- ___ Z Type 304 (CF8) Stainless Steel Body*
- ___ ZM Type 316 (CF8M) Stainless Steel Body

SUFFIXES

- ___ -K Anchor Flange w/ Seepage Holes
- ___ -KC Anchor Flange w/ Seepage Holes and Clamp Collar
- ___ -TS Top Secured with Slotted Screws
- ___ -VP Vandal-Proof Secured Top
- ___ -Y Sediment Bucket

* Regularly furnished unless otherwise specified.