



Model ZCSM-RP

Zurn Connected Remote Pressure Monitor

Architectural/Engineering Specification:

Zurn Connected Pressure Monitors transmit data 24/7 to the Zurn plumbSMART™ web portal and mobile app. Proactively monitor your plumbing system water pressure, receive real-time alerts for preset high and low pressure parameters, and access system data for trends and predictive maintenance anytime and anywhere.

Zurn Connected Remote Pressure Monitors are designed for use and installation anywhere in your plumbing system to continually monitor system water pressure. Plug into existing test ports or tie directly into pipes. Installation is simple and flexible to meet your needs.

Product Features: plumbSMART™ Portal

- Monitor pressure anywhere in your building
- Receive real-time alerts
- Manage maintenance tasks
- Receive insights on your data

Product Features: Connected Remote Pressure Monitor

- Maximum working water pressure of 200 PSI
- End connection: 1/4" male NPT (ANSI/ASME B1.20.1)
- Bleed valve: 1/4" female NPT (ANSI/ASME B1.20.1)
- 1/2" x 1/4" NPT bushing
- 3/4" x 1/2" NPT bushing
- AC wall adapter with 6 foot power cord

Technical Specification:

Electrical Requirements

P6000-ACA: AC adapter:	120vac, 0.2A
Operating Temperature:	20°F to 120°F
Storage Temperature:	-4°F to +175°F
Relative Humidity:	10% – 90%
Pressure Sensor:	Mounted on housing

Connected Endpoint

- Mounts anywhere in your plumbing system
- Communicates wirelessly to Zurn gateway

Zurn Gateway

- Communicates via Ethernet or LTE
- Works with all Zurn connected devices
- Connects all endpoints up to 1,000 ft radius
- After purchase request your gateway at: zurn.com/plumbsmart-gateway or Call 1-844-987-6737

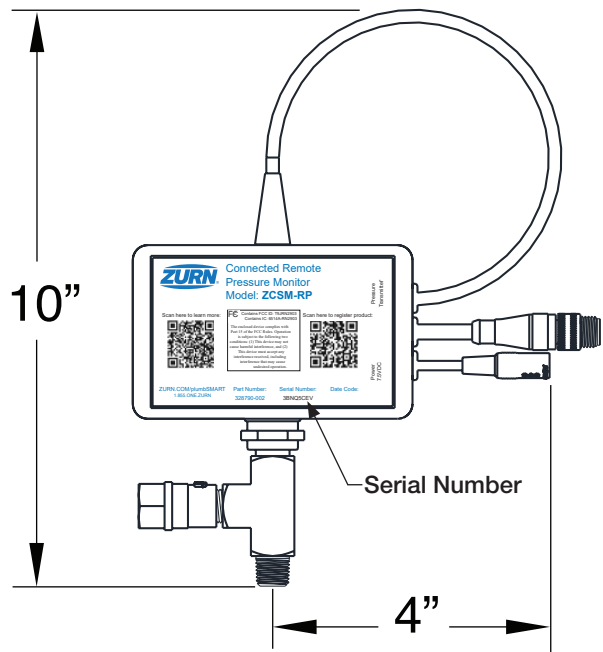

Gateway Options:

(Required & Sold Separately)

- LTE ZGW-LORA-W1-LTE
- Ethernet ZGW-LORA-W1-ETH

Note: plumbSMART™ is free-to-connect to a basic plan

Note: LTE charges will apply to basic plan

Compliance and Certification

- Meets the requirements of NSF/ANSI 61*
*(0.25% MAX. WEIGHTED AVERAGE LEAD CONTENT)

This device complies with Part 15 of the FCC Rules and ISSED Canada RSS Standards.

How it works

The ZCSM-RP Connected Remote Pressure Monitor continuously monitors plumbing system water pressure. Once per hour, water pressure data is transmitted to the plumbSMART™ portal. Facilities managers and/or maintenance personnel can view all data and trends in the plumbSMART™ portal and may opt to receive real-time alerts via email or text message if any of these readings exceed or fall below customizable parameters for high and low pressure levels. All notifications and alert parameters are adjustable via the plumbSMART™ portal. For more information, visit <https://www.zurn.com/innovation-efficiency/plumbsmart>.

Zurn Connected plumbing products are equipped with advanced sensors that track product usage and performance. This data is transmitted wirelessly via the built-in LoRa radio system to a Zurn Gateway, which then sends the data to the Zurn Cloud via Ethernet connection to the local area network (LAN) or via LTE cellular. The LTE cellular option means the data never touches your local network. Algorithms in the Zurn Cloud analyze the data, which is displayed on our secure web portal and mobile app, plumbSMART™. Zurn Connected plumbing products and data from plumbSMART™ may be customized to communicate with existing building management systems (BMS), depending on the communication protocols in use. Each Zurn Connected plumbing product comes with default alert parameters for water pressure, product usage, etc. Alert parameters can be customized in plumbSMART™ based on the specific needs of your building and maintenance protocols. Depending on the functionality of the equipment, some Zurn Connected Products can sense when to act in order to protect your building.

To access the plumbSMART™ portal, a Zurn Gateway must be installed within 1,000 feet of the connected product, and Connected products must be registered with Zurn plumbSMART™. A single Zurn Gateway can be used to connect hundreds of Zurn Connected plumbing products.

Connecting to the plumbSMART™ Portal:

1. Document the serial number from the label on your ZCSM-RP Connected Remote Pressure Monitor.
2. Visit www.zurn.com/plumbSMART-connect to save time and money on your installation. You can also call us at 844-987-6737.
3. Provide the serial number and contact name, email address, and basic information about the installation site.
4. We will activate your plumbSMART™ account, set up your enterprise, and give you guidance on how to register each connected product as you install it.
5. We will send a confirmation email with a link, or you can go to plumbsmart.zurn.com to log into your plumbSMART™ account for the first time.
6. Add other users and installers to your plumbSMART™ account.
7. Make sure you and/or your installers have the plumbSMART™ mobile app, which you can download from the iPhone App Store or Google Play.
8. Using the mobile app, scan or enter the serial number to register and locate each connected plumbing product as you install it.
9. Watch the how-to videos in the plumbSMART™ portal's support section if you get stuck, or call us at 844-987-6737 for support.

