

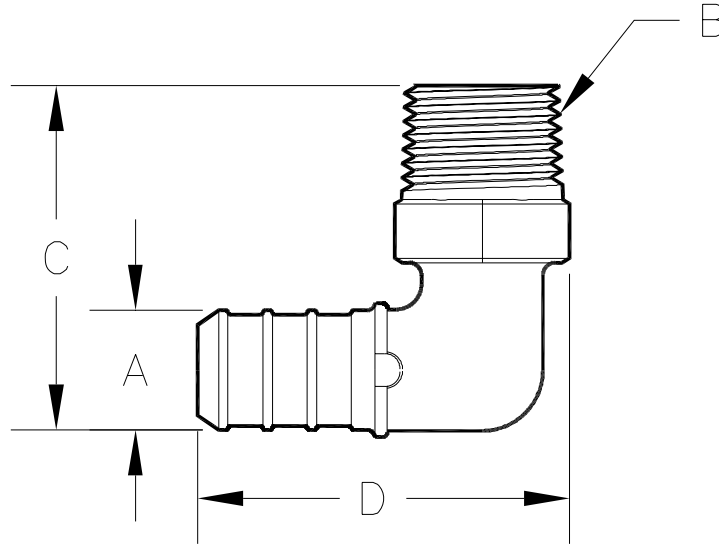

QickSert CR™ Barb x MPT Elbow QQPE__BTX Specification Sheet

Tag _____

Dimensional Data: Inches and [mm] are subject to manufacturing tolerances and change without notice.



Part Number	Description	'A' in [mm]	'B' in [mm]	'C' in [mm]	'D' in [mm]
QQPE32BTX	1/2" Barb x 3/8" MPT Elbow	0.473" [12.0]	3/8" - 18 NPT	1.13" [28.7]	1.13" [28.7]
QQPE33BTX	1/2" Barb x 1/2" MPT Elbow	0.473" [12.0]	1/2" - 14 NPT	1.25" [31.8]	1.25" [31.8]
QQPE44BTX	3/4" Barb x 3/4" MPT Elbow	0.668" [17.0]	3/4" - 14 NPT	1.23" [31.2]	1.42" [36.1]

Engineering Specification: ZurnPEX® QickSert CR™ barb x male thread elbow. The QQPE__BTX elbow to transition from female pipe thread to PEX tubing. Molded from Acudel®. These fittings, as a system with Zurn PEX® tube, are pressure rated at 160 PSI at 73°F, 100 PSI at 180°F, and 80 PSI at 200°F. These fittings are listed by NSF as complying with the following standards: NSF/ANSI Standard 14, NSF/ANSI Standard 61, ASTM F877, and CSA B137.5, and ASTM F2159.

Accessories

- ___ **QCLP3X** 1/2" QickClamp™ Crimp Ring
- ___ **QCLP4X** 3/4" QickClamp™ Crimp Ring
- ___ **QCR3X** 1/2" Copper Crimp Ring
- ___ **QCR4X** 3/4" Copper Crimp Ring

Rev. A	Date: 06/26/08	C.N. No. 98688
Dwg. No. 82185		Prod. No. QQPE__BTX