



QQZBC_CG
Z-Bite™ TRANSITION COUPLING

SPECIFICATION SHEET

TAG _____

Dimensional Data (inches and [mm]) are Subject to Manufacturing Tolerances and Change Without Notice

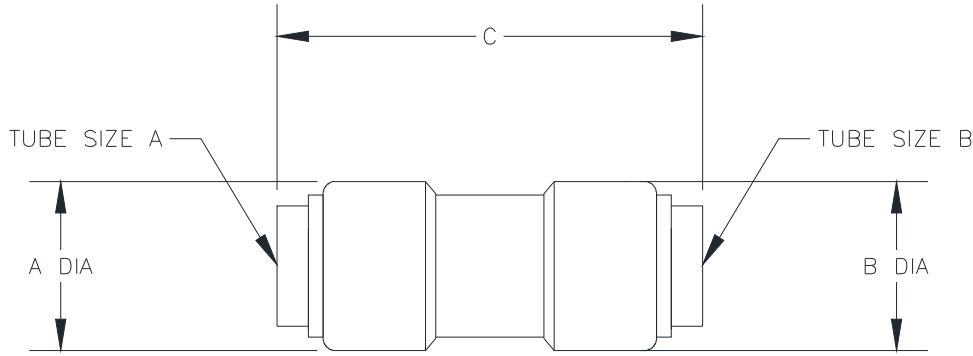

Part Number	Dimensions in Inches [mm]						Bag Qty.	Carton Qty.
	Description	A Dia	Tube A Size	B Dia	Tube B Size	C		
QQZBC33CG	Coupling - 1/2 Z-Bite	1.07 [27]	1/2	1.07 [27]	1/2	1.94 [49]	12	120
QQZBC44CG	Coupling - 3/4 Z-Bite	1.35 [34]	3/4	1.35 [34]	3/4	2.28 [58]	12	60

ENGINEERING SPECIFICATION: QQZBC_CG

Zurn Z-Bite™ Polybutylene (PB) transition fittings are certified by IAPMO to meet the requirements of ASSE 1061 for Push Fit Fittings, NSF Standard 61 for potable water applications and NSF Standard 372 for low lead. The fittings may be used to transition from existing PB plumbing to PEX, CPVC or copper tube sizes. The fittings comply with the requirements of the model plumbing codes for use in inaccessible locations. The grip ring is made from Type 304 stainless steel, the o-ring is a chloramine resistant EPDM and the integral tube stiffeners are made from polysulfone. The brass body of the fitting is C46500 alloy. The end of the coupling with the gray polymer insert is intended for use for PB tube.

ACCESSORIES

- ____ QQZBDC3 1/2 Disconnect Clip
- ____ QQZBDC4 3/4 Disconnect Clip
- ____ QQZBDBT Depth Gage & Deburring Tool, 3/8, 1/2, 3/4 & 1

* Regularly furnished unless otherwise specified.