



QQZBE_G
Z-Bite™ ELBOW

SPECIFICATION SHEET

TAG _____

Dimensional Data (inches and [mm]) are Subject to Manufacturing Tolerances and Change Without Notice

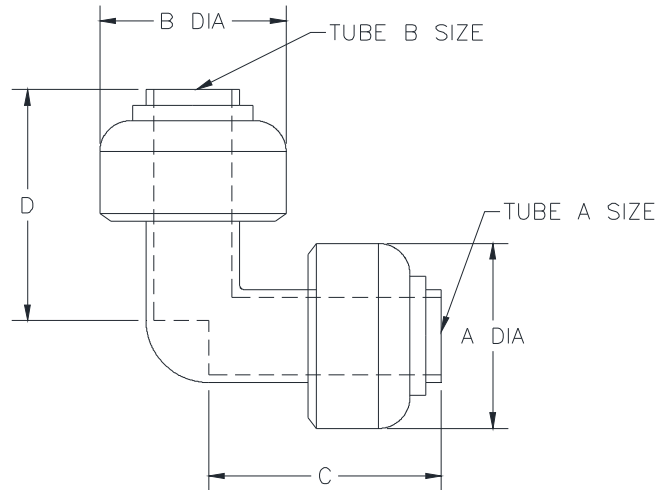

Part Number	Dimensions In Inches [mm]							Bag Qty.	Carton Qty.
	Description	A Dia.	Tube A Size	B Dia.	Tube B Size	C	D		
QQZBE22G	Elbow-3/8 Z-Bite	0.87 [22]	3/8	0.87 [22]	3/8	0.93 [24]	0.93 [24]	6	150
QQZBE32G	Elbow-1/2 x 3/8 Z-Bite	1.07 [27]	1/2	0.87 [22]	3/8	1.30 [33]	1.29 [33]	12	144
QQZBE33G	Elbow-1/2 Z-Bite	1.07 [27]	1/2	1.07 [27]	1/2	1.31 [33]	1.31 [33]	12	120
QQZBE43G	Elbow-3/4 x 1/2 Z-Bite	1.35 [34]	3/4	1.07 [27]	1/2	1.46 [37]	1.44 [37]	12	60
QQZBE44G	Elbow-3/4 Z-Bite	1.35 [34]	3/4	1.35 [34]	3/4	1.58 [40]	1.58 [40]	6	60
QQZBE55G	Elbow-1 Z-Bite	1.66 [42]	1	1.66 [42]	1	1.89 [48]	1.89 [48]	6	30

ENGINEERING SPECIFICATION: ZURN QQZBE_G

Zurn Z-Bite™ Fittings are certified by IAPMO to meet the requirements of ASSE 1061 for Push fit Fittings, NSF Standard 61 for potable water applications and NSF Standard 372 for low lead. The fittings may be used with PEX, CPVC or copper tube sizes. The fittings comply with the requirements of the model plumbing codes for use in accessible locations. The grip ring is made from Type 304 stainless steel, the o-ring is a chloramine resistant EPDM and integral tube stiffener for PEX is made from polysulfone. The brass body of the fitting is C46500 alloy.

ACCESSORIES

- ___ QQZBDC2 3/8 Disconnect clip
- ___ QQZBDC3 1/2 Disconnect clip
- ___ QQZBDC4 3/4 Disconnect clip
- ___ QQZBDC5 1 Disconnect clip
- ___ QQZBDC2 Depth Gage & Deburring Tool: 3/8, 1/2, 3/4 & 1

* Regularly furnished unless otherwise specified.