



Z1727
 ADJUSTABLE FLOOR DRAIN
 MEDIUM-DUTY WITH SQUARE TOP

SPECIFICATION SHEET

TAG _____

Dimensional Data (inches and [mm]) are Subject to Manufacturing Tolerances and Change Without Notice

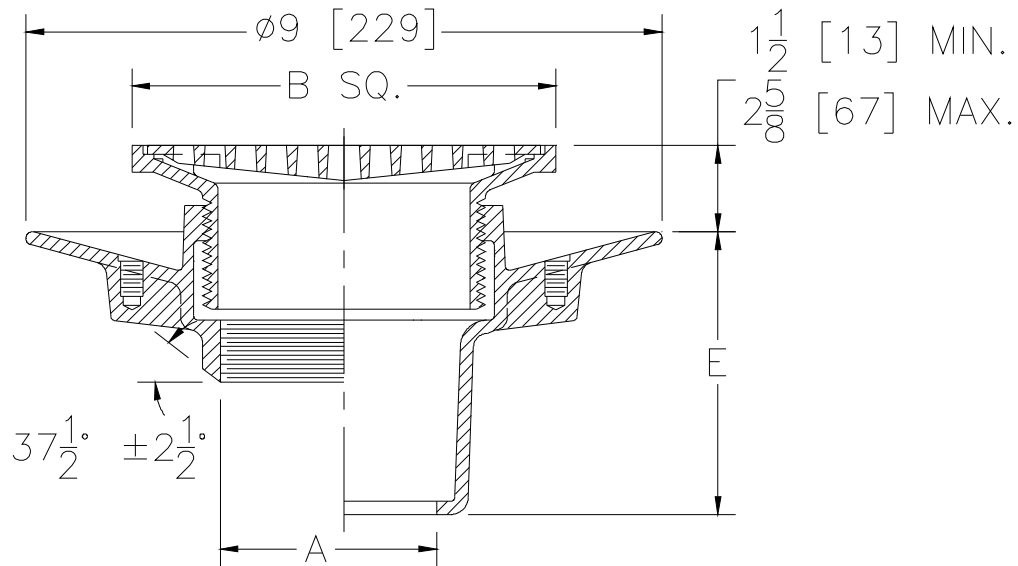

Dimensions in Inches [mm]		Approx. Wt. Lbs. [kg]	Grate Open Area Sq. In. [cm ²]
A Pipe Size In [mm]	Size B		
2,3 [51,76]	5 X 5 [127 X 127]	13 [6]	9 [58]
2,3,4 [51,76,102]	6 X 6 [152 X 152]	14 [6]	13 [84]
3,4,6 [76,102,152]	8 X 8 [203 X 203]	18 [8]	25 [161]

ENGINEERING SPECIFICATION: ZURN Z1727
 All Type 304 (CF8) stainless steel adjustable floor drain with anchor flange (clamp collar with seepage holes, when specified), and 6" [153mm] square medium-duty vertically adjustable satin finish top.

OPTIONS (Check/specify appropriate options)

PIPE SIZE

2,3,4,6 [51,76,102,152]

(Specify size/type) **OUTLET**

___ BW Butt-weld (Specify Sch. 10 or 40)
 ___ IC Inside Caulk
 ___ IP Threaded

'E' BODY HT. DIM.

2-7/8 [73]
 4-3/8 [111]
 2-7/8 [73]

PREFIXES

___ Z Type 304 (CF8) Stainless Steel Body and Top Assembly*
 ___ ZM Type 316 (CF8M) Stainless Steel Body and Top Assembly

SUFFIXES

___ -K Seepage Holes Only
 ___ -KC Clamp Collar with Seepage Holes
 ___ -SQ5 5 [127] Square Type 304 Stainless Steel Top
 ___ -SQ8 8 [203] Square Type 304 Stainless Steel Top
 ___ -VP Vandal-Proof Secured Top
 ___ -Y Stainless Steel Sediment Bucket

* Regularly furnished unless otherwise specified.