

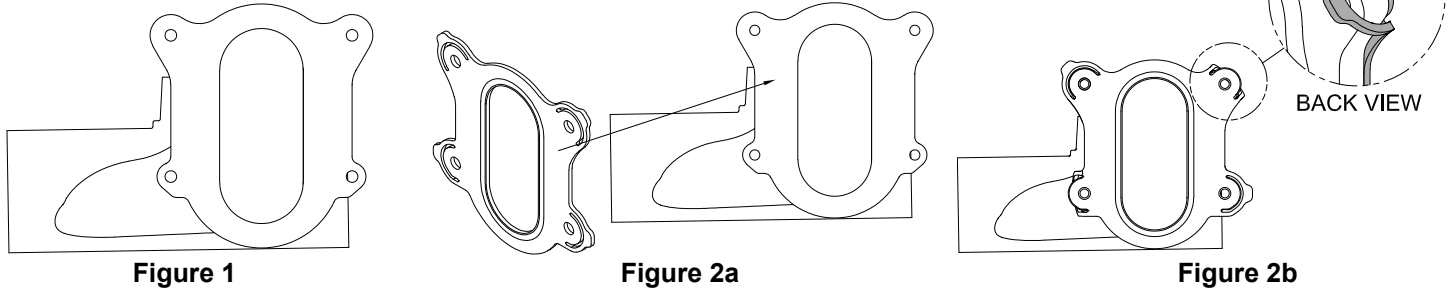


# INSTALLATION INSTRUCTIONS FOR ZN1201, ZF1201, Z1201-XH, AND Z1201-XB WATER CLOSET SYSTEMS

For EZCarry™ Bank Assembly Installation Instructions refer to Zurn form #C46 which can be obtained through the Zurn website.

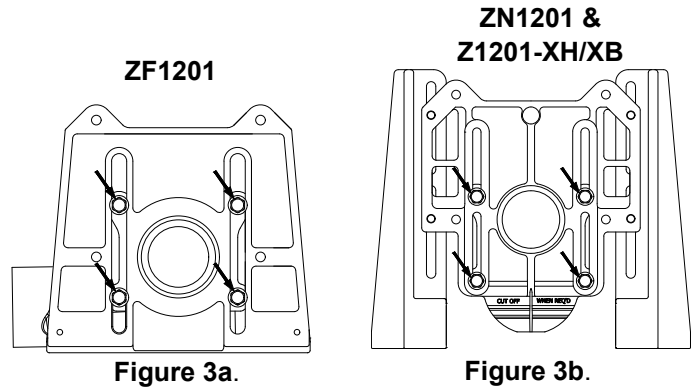
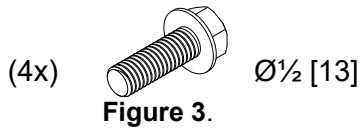
**Step 1** - Lay carrier fitting on floor, waste line barrel down. See **Figure 1**.

**Step 2** - Place QuickFit™ faceplate gasket from trim kit on fitting. Align the gasket holes with the tapped holes in the fitting (**Figure 2a**). Stretch two ears positioned diagonally over the fitting flange (**Figure 2b**).



**Step 3** - Remove the faceplate/feet from trim kit box and align the faceplate slots with the gasket and fitting holes. Secure the (4)  $\varnothing\frac{1}{2}$  [13] bolts, from 66955-332-9 hardware bag, using a torque wrench (25-35 lb-ft of torque) See **Figure 3**.

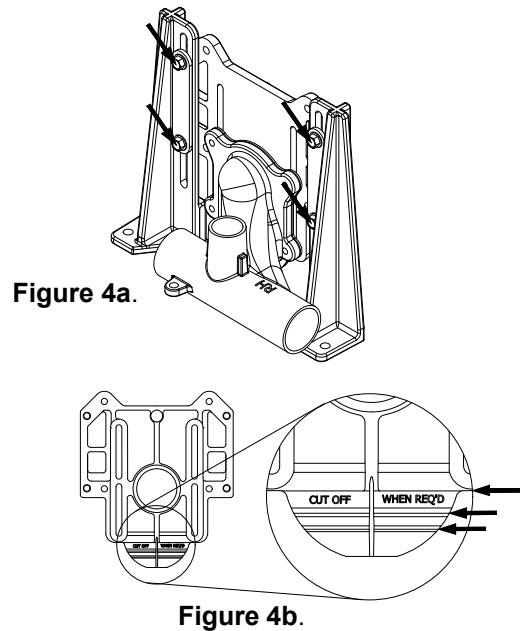
- For ZF1201, see **Figure 3a**.
- For ZN1201 and Z1201-XH/XB, see **Figure 3b**.



**Step 4 - For ZN1201 and Z1201-XH/XB:** To adjust the rough-in height, loosen the feet bolts (see **Figure 4a**) and set the desired height (adding additional height for tiling where required). Secure bolts using a torque wrench (25-35 lb-ft of torque).

**Note:** For certain rough-in heights, the bottom of the faceplate may need to be removed along the defined cut lines. See **Figure 4b**.

**For ZF1201:** The rough-in height is pre-set and cannot be adjusted.



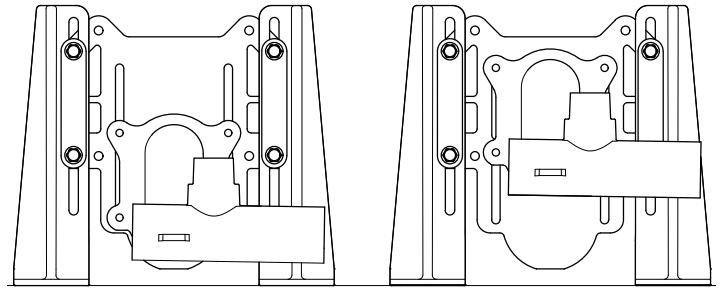
- ⚠ **WARNING:** Cancer and Reproductive Harm - [www.P65Warnings.ca.gov](http://www.P65Warnings.ca.gov)
- ⚠ **ADVERTENCIA:** Cáncer y daño reproductivo - [www.P65Warnings.ca.gov](http://www.P65Warnings.ca.gov)
- ⚠ **AVERTISSEMENT:** Cancer et effets néfastes sur la reproduction - [www.P65Warnings.ca.gov](http://www.P65Warnings.ca.gov)



# INSTALLATION INSTRUCTIONS FOR ZN1201, ZF1201, Z1201-XH, AND Z1201-XB WATER CLOSET SYSTEMS

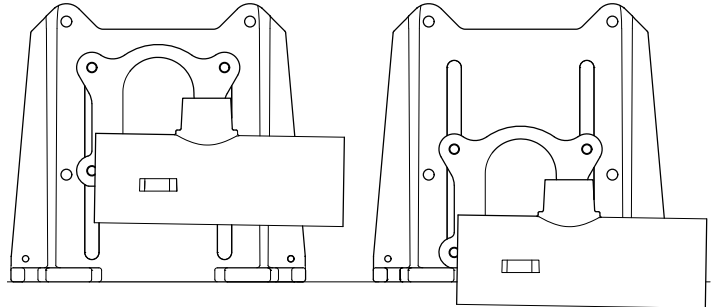
**Step 5** - Standing the assembly upright, loosen the faceplate bolts to adjust the waste line height and pitch as required. Re-secure bolts using a torque wrench (25-35 lb-ft of torque).

- **For ZN1201 & Z1201-XH/XB:**
  - For fitting in the lowest position, see **Figure 5a**.
  - For fitting in the highest position, see **Figure 5b**.
- **For ZF1201**
  - For fitting in the lowest position, see **Figure 5c**.
  - For fitting in the highest position, see **Figure 5d**.



**Figure 5a.**

**Figure 5b.**



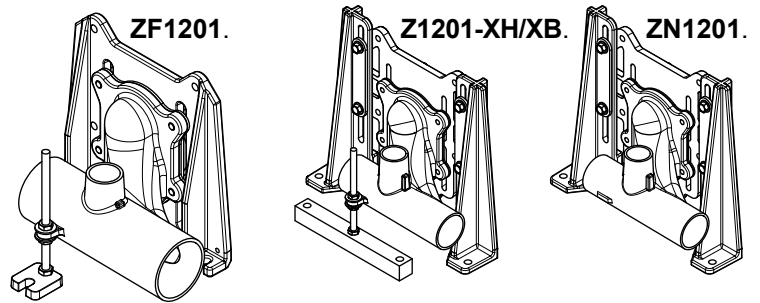
**Figure 5c.**

**Figure 5d.**

**Step 6** - **For ZF1201 and Z1201-XH/XB:** Secure the rear anchor assembly to the fitting using the instructions and hardware provided. Ensure the anchor foot sits level on the floor and nuts are tightened.

- For ZF1201, see **Figure 6a**.
- For Z1201-XH/XB, see **Figure 6b**.

**- For ZN1201:**  
There is not a rear anchor assembly for the ZN1201. See **Figure 6c**



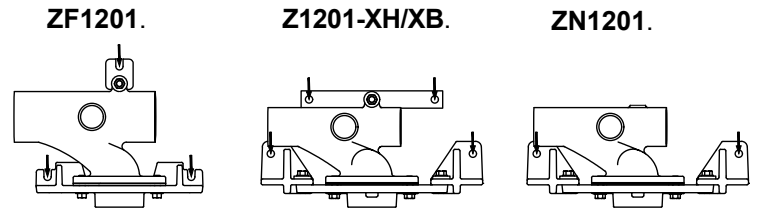
**Figure 6a.**

**Figure 6b.**

**Figure 6c.**

**Step 7** - Align the carrier with the waste line. Mark locations on the floor for anchoring studs.

- For ZF1201, see **Figure 7a**.
- For Z1201-XH/XB, see **Figure 7b**.
- For ZN1201, see **Figure 7c**



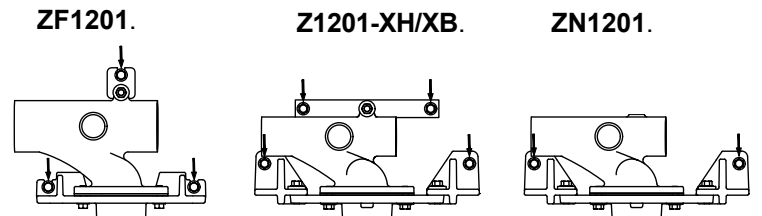
**Figure 7a.**

**Figure 7b.**

**Figure 7c.**

**Step 8** - Prep the floor for concrete anchors and place the carrier back into position. Lag down the feet using min  $\frac{1}{2}$ " [13] to max  $\frac{3}{4}$ " [16] anchors (supplied by others).

- For ZF1201, see **Figure 8a**.
- For Z1201-XH/XB, see **Figure 8b**.
- For ZN1201, see **Figure 8c**



**Figure 8a.**

**Figure 8b.**

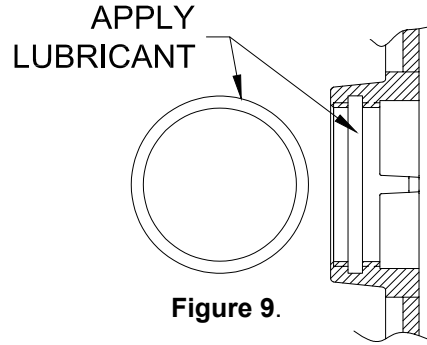
**Figure 8c.**



# INSTALLATION INSTRUCTIONS FOR ZN1201, ZF1201, Z1201-XH, AND Z1201-XB WATER CLOSET SYSTEMS

**Step 9** - Using the o-ring seal and lubricant bag, ensure the o-ring and coupling are well lubricated. Insert the o-ring, ensuring it does not twist. See **Figure 9**.

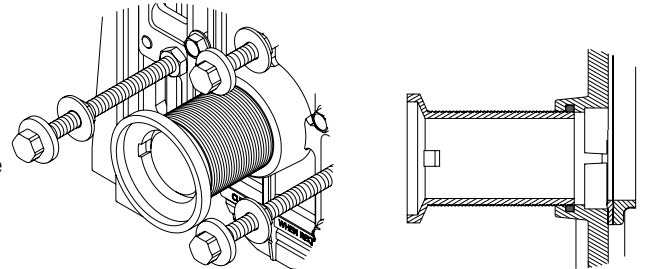
**Note: O-ring installation is critical. Improper installation will cause leakage behind the finished wall.**



**Figure 9.**

## Step 10 - Coupling Installation

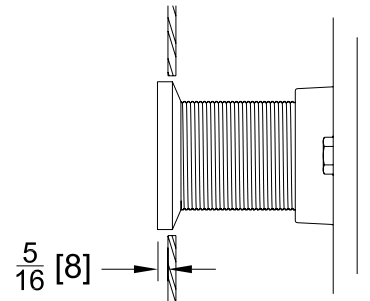
- a. Standard, -CS, and -CC Couplings (Z) - Thread the coupling into the faceplate by hand until it engages the o-ring and begins to resist. Using a coupling wrench (Z1200-CPLG-WRNCH-3 purchased separately), continue to turn the coupling into the o-ring to create a water-tight seal. See **Figure 10**.



**Figure 10.**

Standard, -CS, and -CC Couplings (ZQ) - Thread the coupling into the faceplate by hand until it engages the threads. Using a coupling wrench (Z1200-CPLG-WRNCH-3 purchased separately), continue to turn the coupling to create a water-tight seal.

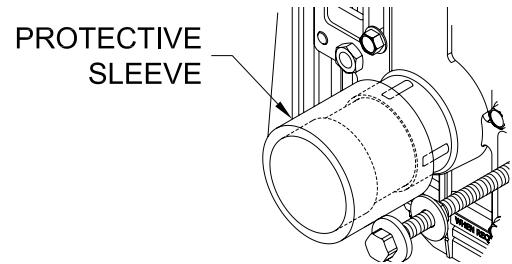
Adjust the coupling to extend 5/16" [8mm] from the finished wall. Ensure the coupling threads are protected from debris adhesion to allow adjustment after the wall is in place. If the coupling must be shortened, cut from the threaded end. Prevent damage to the o-ring by chamfering the cut end and thoroughly deburring. See **Figure 10a**.



**Figure 10a.**

- b. EZ-Set™ Coupling (Z) - Thread the coupling into the faceplate by hand until it engages the o-ring and begins to resist. Using a strap or pipe wrench, continue to turn the coupling into the o-ring to create a water-tight seal. Ensure the protective sleeve is flush with the test cap. See **Figure 10a & 10b**.

EZ-Set™ Coupling (ZQ) - Thread the coupling into the faceplate by hand until the threads engage. Using a strap or pipe wrench, continue to turn the coupling into the faceplate to create a water-tight seal. Ensure the protective sleeve is flush with the test cap. See **Figure 10b**.



**Figure 10b.**



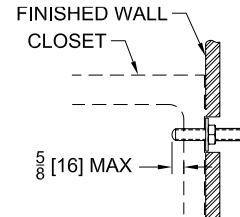
# INSTALLATION INSTRUCTIONS FOR ZN1201, ZF1201, Z1201-XH, AND Z1201-XB WATER CLOSET SYSTEMS

**Step 11** - Prep for finished wall. Fasten the (4) threaded rods from the finish bag into the faceplate, using the (4) jam nuts to tighten the studs down. Each rod extends 5/8 [16] past the closet bowl flange. See **Figure 11a**.

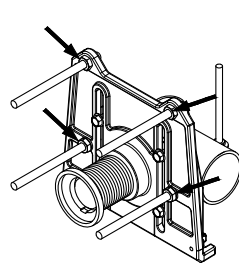
- For ZF1201, see **Figure 11b**.
- For ZN1201 & Z1201-XH/XB, see **Figure 11c**.

**Note:** If the studs are too long they will bottom out in the finishing cap nut, preventing proper gasket compression which may result in leakage.

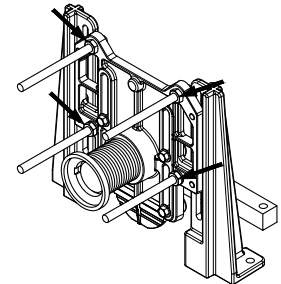
**Note:** For more installation instructions for Z1201-XB, see the instruction sheet that is inside the P1201-XB box.



**Figure 11a.**

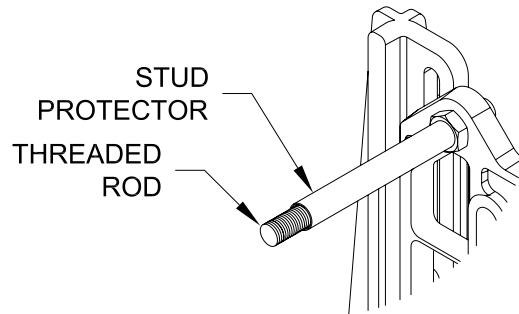


**Figure 11b.**



**Figure 11c.**

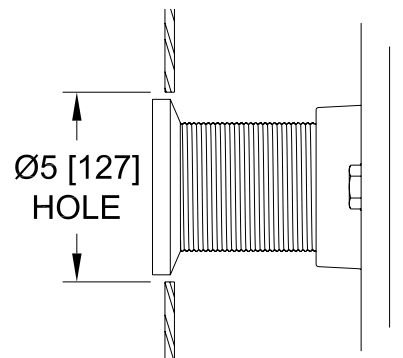
**Step 12** - Slide plastic stud protectors onto the threaded rods. See **Figure 12**.



**Figure 12.**

**Step 13** - Perform 10-ft head pressure test and/or other testing required by your local plumbing code.

**Step 14** - Finished wall should be installed. Ensure appropriate size opening is made for coupling. For EZ-Set™ Coupling hole sizing. See **Figure 14**.



**Figure 14.**



# INSTALLATION INSTRUCTIONS FOR ZN1201, ZF1201, Z1201-XH, AND Z1201-XB WATER CLOSET SYSTEMS

## Step 15 - Finish Coupling Preparation

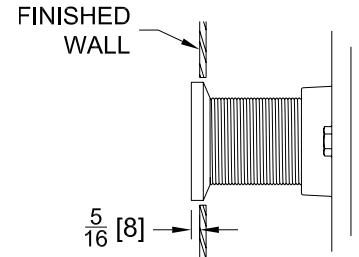
- a. Standard, -CS, and -CC Couplings – Remove coupling protector. Ensure coupling extends 5/16" [8mm] from finished wall. See **Figure 15a**.

Knock out the test cap with a hammer and deburr sharp edges (-CS coupling only). See **Figure 15b**.

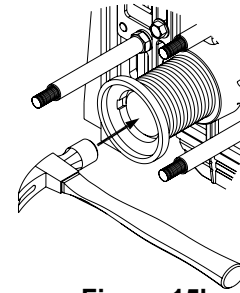
**Note: EZ-Set™ Couplings 14" and longer, test cap must be cut off. The knock-out feature is not applicable with 14" and longer EZ-Set™ couplings.**

- b. EZ-Set™ Coupling (using knock-out feature) – Remove coupling protector. Ensure coupling is flush with the finished wall. Knock out the test cap with a hammer and deburr sharp edges. See **Figure 15b**.

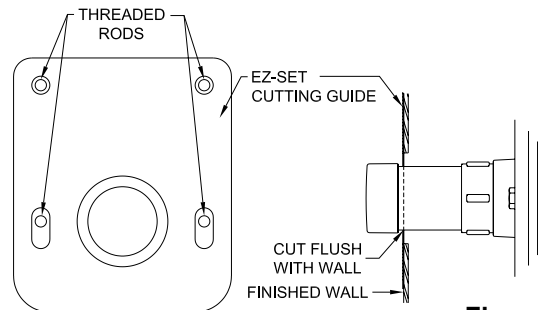
- c. EZ-Set™ Coupling (cutting off test cap) – Remove coupling protector. Hang the EZCUTGUIDE (purchased separately) See **Figure 15c**.



**Figure 15a.**



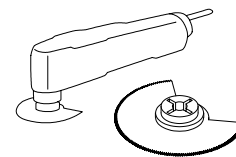
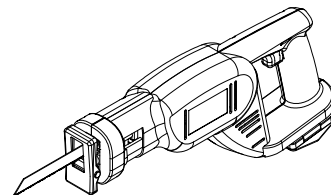
**Figure 15b.**



**Figure 15c.**

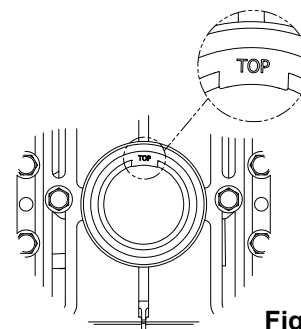
- d. Using a reciprocating saw or oscillating multi-tool, cut flush with EZCUTGUIDE and remove the test cap and excess coupling length. Deburr sharp edges. See **Figure 15d**.

Remove EZCUTGUIDE.



**Figure 15d.**

- e. Prep the coupling end and flange, following PVC Cement manufacturer's instructions. Glue flange to pipe with "TOP" properly aligned. See **Figure 15e**.

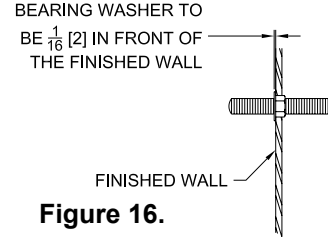


**Figure 15e.**



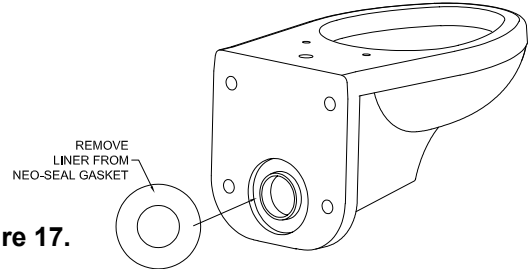
# INSTALLATION INSTRUCTIONS FOR ZN1201, ZF1201, Z1201-XH, AND Z1201-XB WATER CLOSET SYSTEMS

**Step 16** - Thread a backup nut and bearing washer onto each 5/8" [16mm] rod. Adjust hardware so that the front surface of each flat washer is 1/16" [2mm] in front of the finished wall. All bearing washers must be in the same plane to support the fixture and prevent cracking. See **Figure 16**.



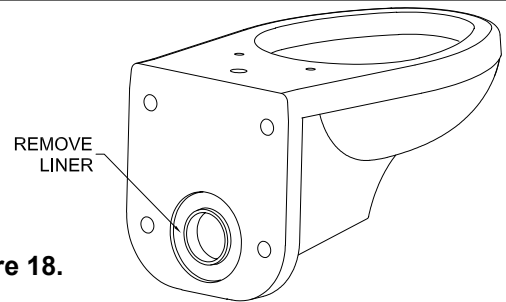
**Figure 16.**

**Step 17** - Peel off the removable backing from one side of the Neo-Seal Gasket and seat into the groove of the water closet outlet horn. See **Figure 17**.



**Figure 17.**

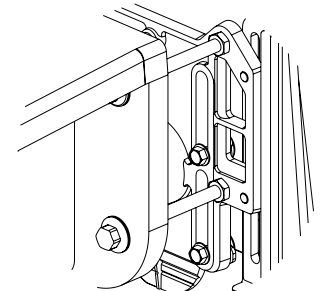
**Step 18** - Peel off removable backing liner from the opposite side of the gasket and hang the water closet onto the threaded rods. Ensure Neo-Seal gasket seals to the coupling. See **Figure 18**.



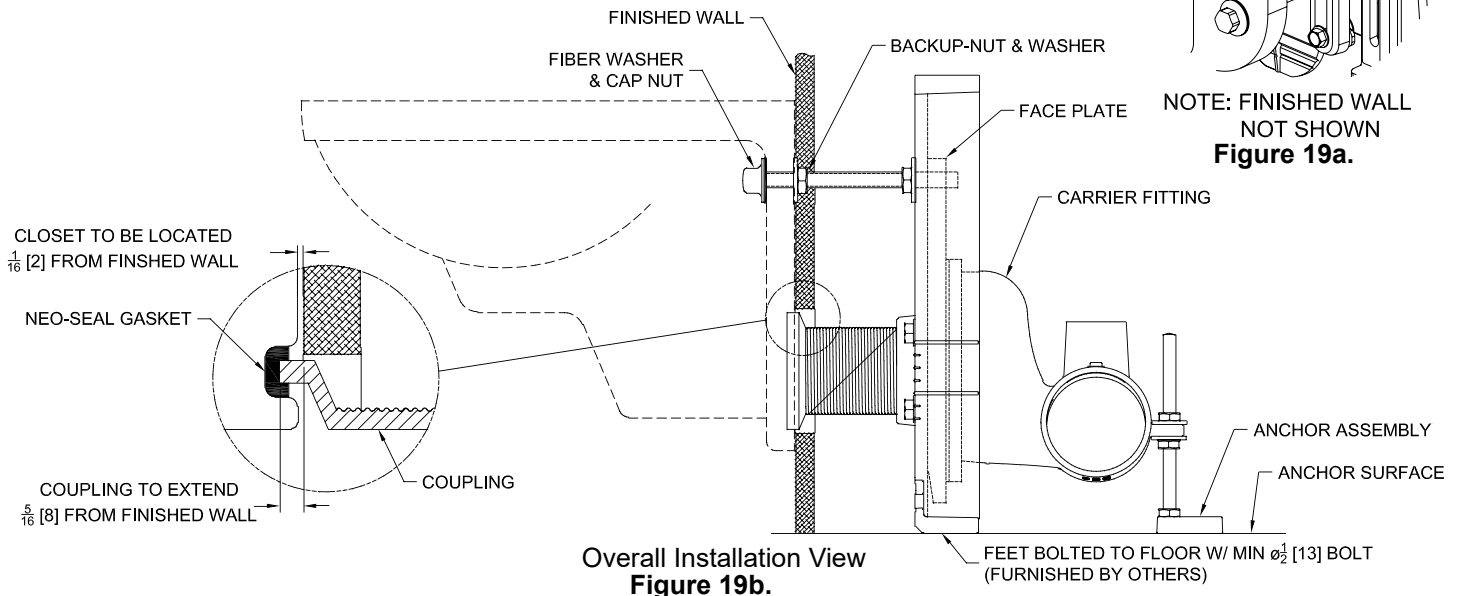
**Figure 18.**

**Step 19** - Assemble a fiber washer and cap nut onto each rod and hand tighten. Secure closet with an additional half-turn using a wrench on each nut to complete the installation. See **Figure 19a & 19b**.

**Note:** The closet should not make contact with the finished wall.



**NOTE: FINISHED WALL NOT SHOWN  
Figure 19a.**



**Overall Installation View  
Figure 19b.**