



Z1820-8B

8 [203] DIAMETER ROUND INDUSTRIAL SIDE OUTLET FLOOR DRAIN

SPECIFICATION SHEET

TAG _____

Dimensional Data (inches and [mm]) are Subject to Manufacturing Tolerances and Change Without Notice

Engineering Specification: ZURN Z1820-8B

8 [203] Diameter, 18 gage, all type 304 (CF8) stainless steel round industrial floor drain with 1.25° pre-sloped side outlet, loose set anti-tilt heavy-duty perimeter drainage cover, reinforced top frame, perforated removable sediment bucket with lift handle, and pre-pour stabilizing anchor tabs.

Approx. Wt. Lbs. [kg]	Grate Open Area Sq. In. [cm ²]
7 [3]	6.1 [39]

Options (Check/specify appropriate options)

Pipe Size (ØA) (Specify size/type)	Outlet	E Body Ht. Dim.	F
2 [51] ___ BW	Butt-Weld (Sch. 10)	6 [152]	3-1/2 [89]
3 [76] ___ BW	Butt-Weld (Sch. 10)	6 [152]	3-1/2 [89]
4 [102] ___ BW	Butt-Weld (Sch. 10)	6-1/2 [165]	3 [76]
2 [51] ___ NH	No-Hub	6 [152]	3-1/2 [89]
3 [76] ___ NH	No-Hub	6 [155]	3-1/2 [89]
4 [102] ___ NH	No-Hub	6-1/2 [165]	3 [76]

Prefixes

- ___ Z Type 304 (CF8) Stainless Steel*
- ___ ZM Type 316 (CF8M) Stainless Steel

Suffixes

- ___ -B Bell Trap/Solid Sediment Bucket
- ___ -P ø1/2 [13] Trap Primer Connection
- ___ -SA Stabilizer Assembly (Z1035)
- ___ -SQ Stabilizer Q-Deck (Z1035-Q)
- ___ -TS Top Secured Grate
- ___ -VH Vacuum Handle (-GCH Cover Only)

Grate Options

- ___ -GCH Heavy-Duty Gas Tight Solid Cover
- ___ -PCX Extra-Heavy-Duty Perimeter Drainage Cover (6.1 Sq. In. [39 cm²] Open Area)
- ___ -PGM Medium-Duty Perforated Grate (9.9 Sq. In. [64 cm²] Open Area)
- ___ -SGH Heavy-Duty Slotted Grate (11.2 Sq. In. [72 cm²] Open Area)
- ___ -SGM Medium-Duty Slotted Grate (11.2 Sq. In. [72 cm²] Open Area)

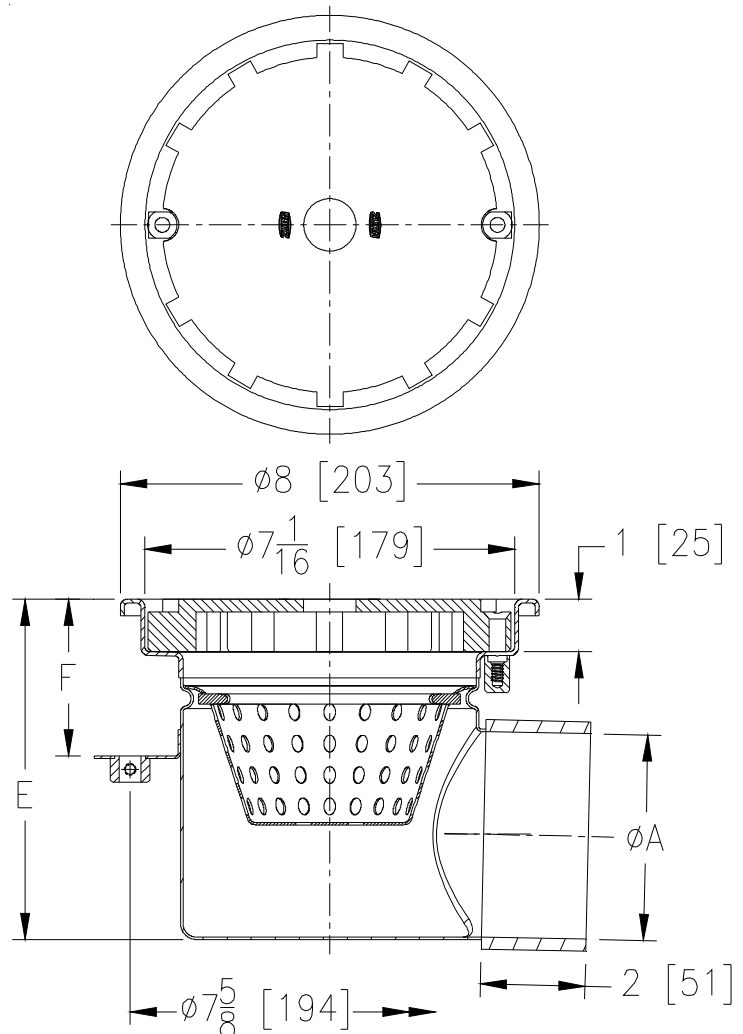

* Regularly furnished unless otherwise specified.