



ZPT1 ZURN POD PRO SHALLOW STAINLESS STEEL LINEAR DRAIN WITH MEMBRANE FLANGE & DROP IN OUTLET

SPECIFICATION SHEET

TAG _____

Grate Design and Dimensional Data (inches and [mm]) are Subject to Manufacturing Tolerances and Change Without Notice

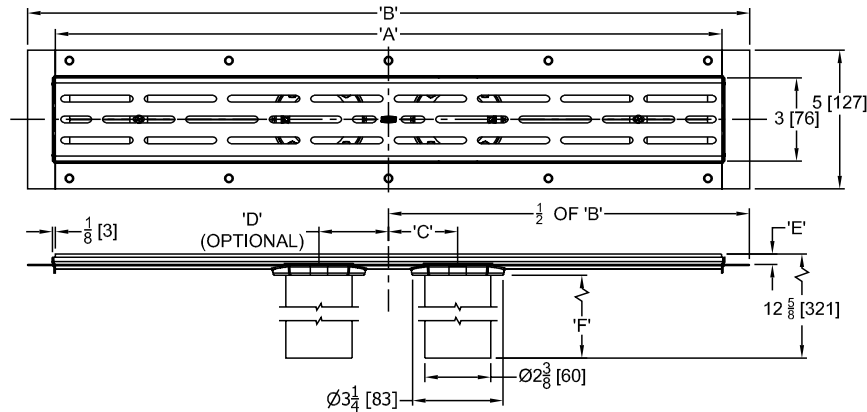

Grate Option -LS shown

Dimensions in Inches [mm]					
Product Designation	'A'	'B' (Dim A+2")	'C'	'E'	'F'
-24	24 [610]	26 [660]	2-1/2 [64]	3/8 [10]	12 [350]
-30	30 [762]	32 [813]			
-36	36 [914]	38 [965]			
-42	42 [1067]	44 [1118]			
-48	48 [1219]	50 [1270]			
-54	54 [1372]	56 [1422]			
-60	60 [1524]	62 [1575]			

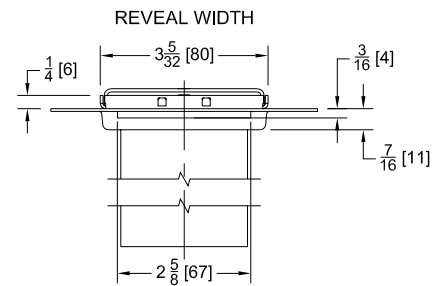

ENGINEERING SPECIFICATION: ZURN ZPT1

ZPT1 ZURN POD Pro Shallow Linear Drain with Membrane Flange and Drop-In Outlet is engineered to reduce installation time and provide job site flexibility. Zurn's shallowest sanitary Linear Drain comes standard with low-profile, 1/2" [13mm] deep, Type 304, 18 gauge fabricated stainless steel anti-ponding V-shaped channel with independent 2" [51mm] No-Hub offset, Type 304, stainless steel drop-in bottom outlet that is 12" [350mm] long. The linear drain also comes standard with an integral membrane flange for glue on waterproofing membranes, neoprene outlet gasket, and a secured 13 gauge stainless steel, heel-proof, light-duty slotted grate with combination tiling edge and integrated grate lockdown. Drain is designed for shallow subfloor installations where concrete may not be present and can be custom ordered to accommodate 1/4" [6mm] to 3/4" [19mm] finished tile thicknesses in 1/8" [3mm] increments.

GRATE OPTIONS

- ___ -BW Basket Weave Grate
- ___ -DB Decorative Block Grate
- ___ -WG Wave Grate
- ___ -LS Slotted Grate*

SUFFIXES

- ___ -CLO Custom Length Outlet (Specify Dimension F in 1" [25] increments) _____ (Min. 4 [102] Max. 24 [610], Minimum 6 [153] For Use With -TSP)
- ___ -CLT Custom Length Trench (Specify Dimension A in 1" [25] increments) _____ (Min. 14 [356] Max. 120 [3048]; -TBO required if grate is longer than 60 [1524])
- ___ -EXT Custom Height Grate (Specify Dimension E in 1/8" [3] increments) _____ (Min. 3/8 [10] Max. 7/8 [22])
- ___ -FS Outlet Filter Screen (Cannot Be Used With -TSP)
- ___ -OL Outlet Location (Specify Dimension C in 1" [25] increments) _____ (Outlet must be at least 6 [152] away from the ends of the trench) Note: For optimal flow performance, outlet should be within 2.5 [64] of center of trench.
- ___ -TBO Two Bottom Outlets (Specify Dim 'C' in 1" [25] increments) _____ (and 'D' in 1" [25] increments) _____ (Distance between outlets is 7 [178] min and 60 [1524] max. Outlets must be at least 6 [152] away from the ends of the channel.) Note: For optimal flow performance, outlets should be evenly spaced along the length of the trench.
- ___ -TSP Trap Seal Protection Device (See ZPTSP)
- ___ -VP Vandal-Proof Screws

*Regularly furnished unless otherwise specified.

- ⚠ **WARNING:** Cancer and Reproductive Harm - www.P65Warnings.ca.gov
- ⚠ **ADVERTENCIA:** Cáncer y daño reproductivo - www.P65Warnings.ca.gov
- ⚠ **AVERTISSEMENT:** Cancer et effets néfastes sur la reproduction - www.P65Warnings.ca.gov

Zurn Industries, LLC | Specification Drainage Operation
1801 Pittsburgh Avenue, Erie, PA 16502, Ph. 855.663.9876

In Canada | Zurn Industries Limited
7900 Goreway Drive, Unit 10, Brampton, Ontario L6T 5W6, Ph. 877.892.5216

www.zurn.com

Rev. E
Date: 8/14/2024
C.N. No. 146270
Patent zurn.com/patents
Prod. | Dwg. No. ZPT1

Page 1 of 2



Grate Design and Dimensional Data (inches and [mm]) are Subject to Manufacturing Tolerances and Change Without Notice

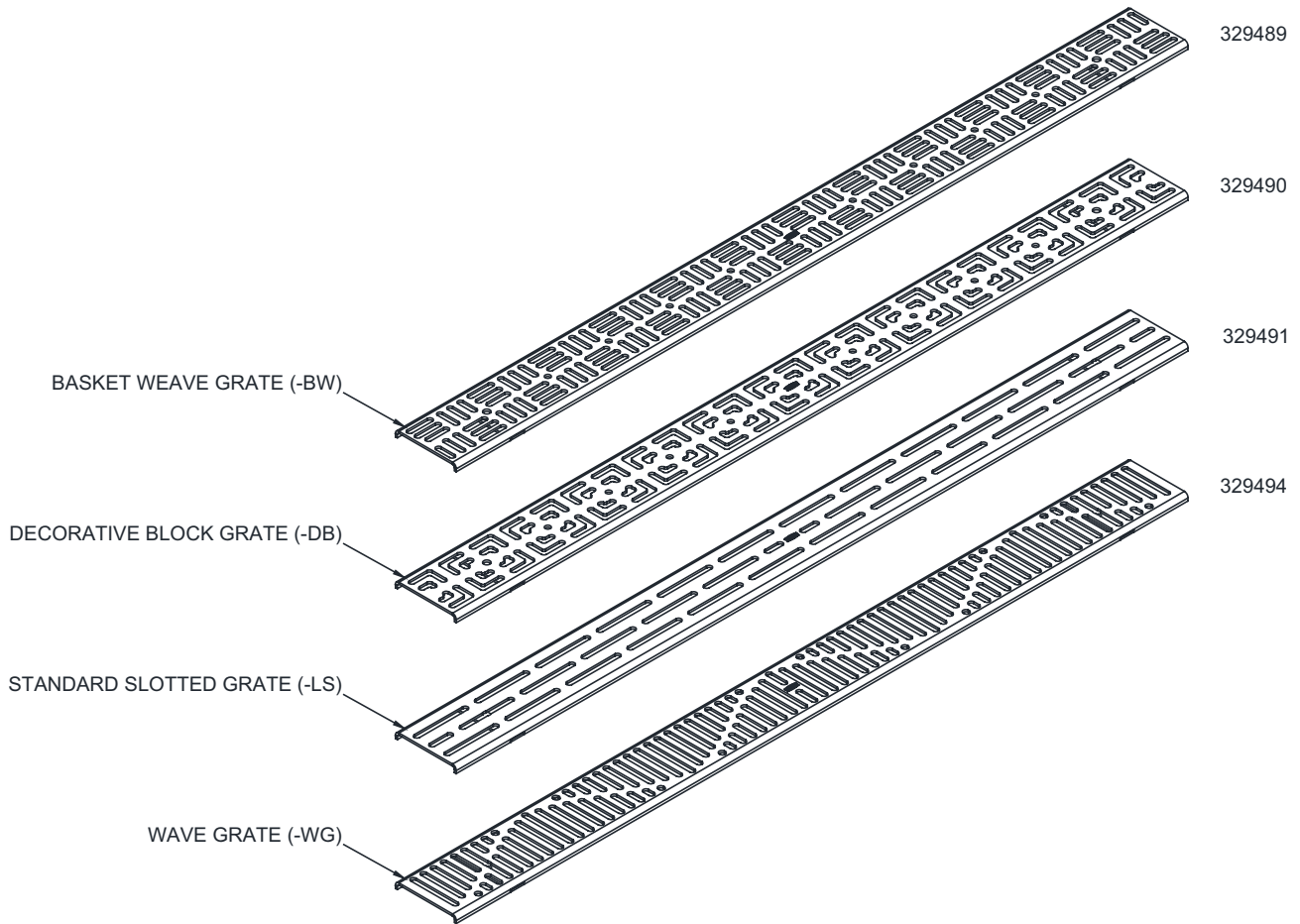

PRODUCT DESIGNATION	LENGTH IN. (MM)	OPEN AREA - SQ. IN [CM ²]			
		STD. SLOTTED	BASKET WEAVE	DECORATIVE BLOCK	WAVE GRATE
-24	24	15.22 [98.2]	25.69 [165.8]	20.43 [131.8]	25.37 [163.7]
-30	30	19.03 [122.8]	31.12 [207.2]	25.54 [164.7]	31.75 [204.8]
-36	36	22.84 [147.3]	38.54 [248.6]	30.64 [197.7]	38.30 [247.1]
-42	42	26.64 [171.9]	44.96 [290.1]	35.75 [230.6]	44.68 [288.2]
-48	48	30.45 [196.5]	51.39 [331.5]	40.86 [263.6]	51.22 [330.5]
-54	54	34.26 [221.0]	57.81 [372.9]	45.97 [296.5]	57.60 [371.6]
-60	60	38.06 [245.6]	64.24 [414.4]	51.07 [329.5]	64.15 [413.9]
OPEN AREA IN ² /FT [CM ² /M]		7.61 [161.1]	12.79 [270.7]	10.21 [216.1]	12.76 [270.1]

⚠ WARNING: Cancer and Reproductive Harm - www.P65Warnings.ca.gov

⚠ ADVERTENCIA: Cáncer y daño reproductivo - www.P65Warnings.ca.gov

⚠ AVERTISSEMENT: Cancer et effets néfastes sur la reproduction - www.P65Warnings.ca.gov

Zurn Industries, LLC | Specification Drainage Operation
1801 Pittsburgh Avenue, Erie, PA 16502, Ph. 855.663.9876

In Canada | Zurn Industries Limited
7900 Goreway Drive, Unit 10, Brampton, Ontario L6T 5W6, Ph. 877.892.5216

www.zurn.com

Rev. E
Date: 8/14/2024
C.N. No. 146270
Patent zurn.com/patents
Prod. | Dwg. No. ZPT1